



Project name:		Type
Catalog number:		
Location:		
Date:		
Comments:		

# SLEEK-1B

## ORDERING INFORMATION

Product Code	Description	Color	Part Number
SLEEK-1B-WHITE	Single Gang Momentary Contact Switch, Low Voltage, 1 Button, N.O.	White	99601
SLEEK-1B-IVORY	Single Gang Momentary Contact Switch, Low Voltage, 1 Button, N.O.	Ivory	99602
SLEEK-1B-ALMOND	Single Gang Momentary Contact Switch, Low Voltage, 1 Button, N.O.	Light Almond	99603
<b>Accessories</b>			
ENGRAVING-1	Custom Laser Engraving Adder (per switch), 1 Button	Any	60058



## TOP FEATURES

- Clean and attractive styling
- Reliable, medium sized buttons with optional custom label engraving available
- Fits standard size and depth single-gang switch box
- Screw-less cover plate included
- Three color choices

## DESCRIPTION

The SLEEK series is an attractive button contact closure wall station compatible with B.E.G. Controls PP series power packs. The wall station connects to the power pack switch inputs for on/off switching and/or raise/lower dimming functionality depending on the power pack model features. The buttons are reliable and easy to actuate.

The SLEEK button station includes a snap-on plastic wall plate for a screw-less finish, and can be installed in any standard single-gang switch box. Wiring is simply two wires per button. Mounting hardware is included.

The SLEEK button station can be used for any application that requires a low voltage normally-open momentary dry contact closure. Custom laser-engraved labeling is an available option.

## OPERATION

The buttons provide on/off switching and/or raise/lower dimming functionality depending on the power pack model features. The button is normally open. Press the button to close the contact, and then release the button to open the contact.

For power packs that feature switching of loads only, a short press of the button will alternately switch the relay on or off. For power packs that feature switching and dimming of loads, a short press of the button will alternately switch the relay on or off, and a long press will raise or lower the light level. Press and hold the button to dim, and to reverse direction release the button and then press and hold it again.

## APPLICATIONS

---

- **Indoor applications:**
  - Vacancy sensor application (requires a wall switch manual on)
  - Sensor application requiring a wall switch override
  - Application requiring a dry contact input to a control system by others

## PRODUCT INFORMATION

---

- Designed for indoor use and dry locations only
- Works with B.E.G. power packs, sensors, and other devices with low voltage switch inputs. Can be used with any control systems by others that requires a low voltage, momentary dry contact input button
- Available in three color choices
- Custom laser-engraved button label option is available (limit 8 characters per line, 3 lines per button)
- Compatible with single-gang wall switchboxes
- Buttons are low voltage momentary dry contact, normally open
- Buttons are two-wire with independent commons for flexibility in wiring
- Mounting hardware and screw-less single-gang plastic wall cover plate is included
- ROHS and REACH compliant
- 5 years limited warranty

## TECHNICAL DETAILS

---

<b>Switching:</b>	Momentary, normally open Single pole, single throw
<b>Contact:</b>	Dry contact
<b>Electrical:</b>	Low Voltage, Class 2 1.0 A @ 28 V AC/DC
<b>Suitable Environment:</b>	32 - 140°F / 0 - 60°C Dry location (non-condensing)
<b>Dimensions:</b>	2.875 in x 1.5 in x 5.3125 in 173 x 38 x 135 mm
<b>Weight:</b>	0.5 lbs

**B.E.G.**

Controls

**WIRING DIAGRAM**

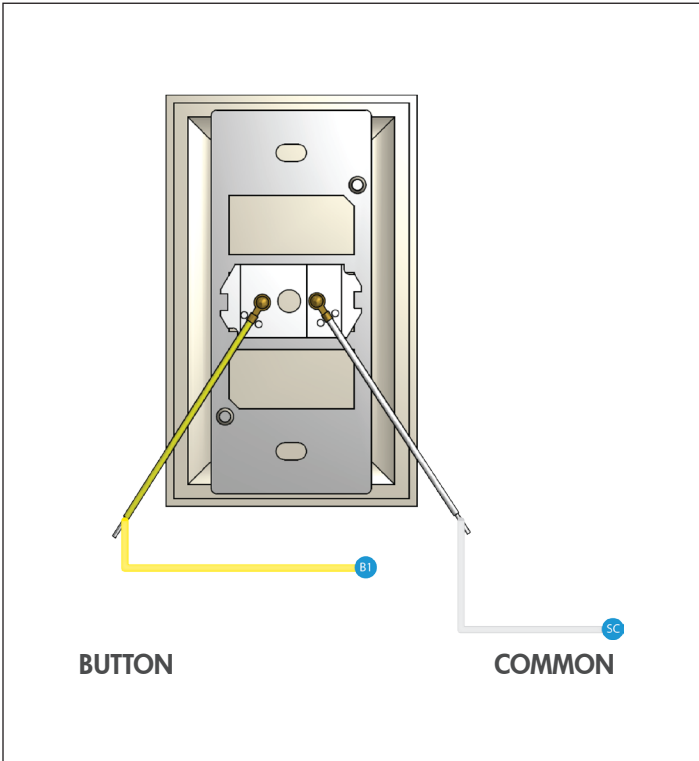

**DIMENSIONS DRAWING**

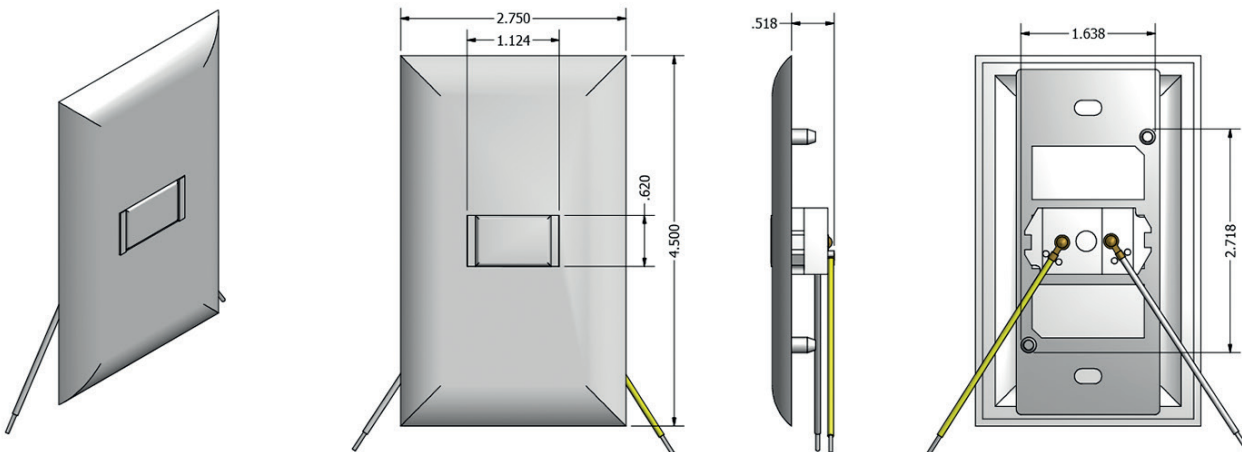

Note: Product specifications are subject to change without notice.  
Please consult the B.E.G. Controls web site for the most recent product specifications.